



Our **NEW** ThermoGuard<sup>TM</sup> polyurethane doors build on the Midland tradition of building doors that our dealers love to install and customers are proud to own. Our ThermoGuard doors feature a proprietary polyurethane insulation that is environmentally friendly and provides an exceptional R-value for maximum insulating power.

Our value doesn't stop there. ThermoGuard doors are built to last using custom, heavy-duty galvanized hardware and commercial-grade Alcryn<sup>®</sup> bulb joint seal for both residential and commercial applications. For added beauty and durability, we conceal full-height center stiles and tailor-make custom end stiles. We build our ThermoGuard series using a patented new process that offers improved manufacturing precision and efficiency compared to other doors on the market.

# WARM AND INVITING, INSIDE AND OUT

Our **NEW** ThermoGuard doors are available in 2- and 3-inch thicknesses for commercial and 2-inch residential use. The new, custom-blend polyurethane couples with an abundance of thermal components to efficiently cut energy expenses while also acting as a sound barrier.

For an exceptional R-value, we incorporate commercial-grade seals to separate the internal and external skins and a durometer seal for a tight barrier between the door and jamb. The design keeps moisture out while standing up to extreme temperatures.

## INSULATION

	Commercial	Residential
Thickness	3 inches	2 inches
Maximum Width	40 feet 2 inches	32 feet 2 inches
Foam/Insulate	Polyurethane	Polyurethane
R-Value	26.0	18.0
Exterior Steel	27 gauge optional 20-gauge upgrade available in white only	27 gauge optional 20-gauge upgrade available in white only
Interior Steel	27 gauge	27 gauge
Warranty* Excludes Springs	10 years	10 years

\*For full warranty details, contact your Midland dealer.

### Extreme Durability

Alcryn bulb joint seal holds up in temperatures from -130° F to 225° F.

### Lower Energy Costs

Polyurethane insulation helps maintain building temperature.

### Moisture Resistant

Closed-cell end dam and bottom extrusion seals form a tight barrier.

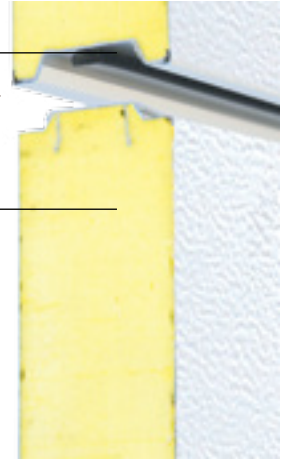

## COLOR AND STYLE

For style and character to complement any home, choose from our full range of premium options. For most colors, ThermoGuard doors feature 30-year Valspar® WeatherXL™ paint to provide decades of chalk and fade resistance. Valspar Diamond Guard® paint provides greater durability for our white doors. Woodgrain exteriors come standard with a protective clear coat finish.

### CHOOSE YOUR COLOR

Due to printing processes, colors may not be an accurate representation of the final product. Please contact your Midland dealer for authentic color swatches or further details.

#### Residential Colors

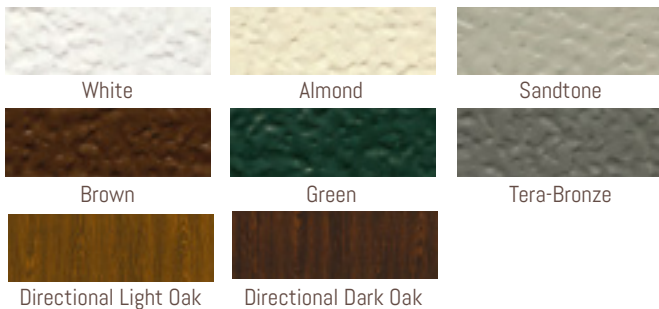

#### Commercial Colors



Consult your Midland dealer for custom color options.



**West Fargo, ND 58078**  
675 12th Ave. NE | 800-437-4056

**Eden Prairie, MN 55344**  
6775 Shady Oak Road | 800-521-0047

**Omaha, NE 68138**  
13661 Giles Road | 800-533-8358

[www.midlandgaragedoor.com](http://www.midlandgaragedoor.com)

Every effort has been made to use accurate photography, drawings, product specifications and descriptions at the time of printing. However, because of continuous progressive product improvements, all specifications and descriptions are subject to change without prior notice. Certain features shown are non-stock items and may be purchased through Midland Garage Door Manufacturing Company's sales offices or through an authorized dealer.

© 2017 Midland Garage Door Mfg. Co. Inc. All rights reserved. 0417